



Receiving a secure email from Connect Health - Smartphone

Connect Health are now able to send patients secure emails with attachments such as appointment letters, home exercise programmes, clinical letters etc.

You will need an app called 'OME Viewer' to open the message.

If you do not have OME Viewer you will need to download this from the app store.

When you receive our email, it should look like the below:

Encrypted message from Connect Health secure messaging system
To view your message
Save and open the attachment (message.html), and follow the instructions.
Sign in using the following email address:

Tap and hold the attachment.

This message is confidential for the use of the addressee only. You will need to DOWNLOAD the message.html to your device and open it to view the email. If you require assistance, more information on how to access this email can be found here:
<http://tn.connectphc.co.uk/6365/ch-encrypted-email-help-guide.pdf>

Message encryption by Microsoft Office 365

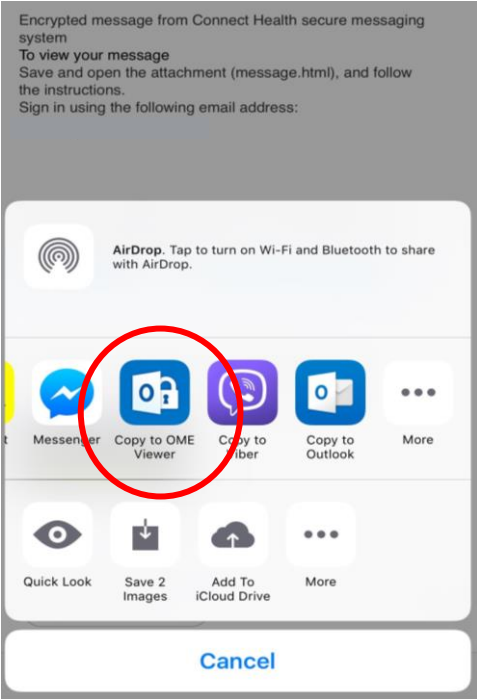
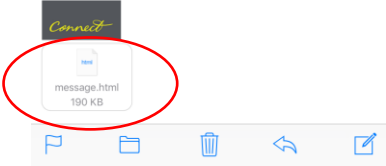

Select 'copy to OME Viewer' and follow the Instructions.